

Installation Instructions
4000 Series Side Steps Part Number 4235 (B-C-PS)
2015-2016 Chevrolet Colorado & GMC Canyon Crew Cab
Do not attempt to install this product on any vehicle other than the one listed above!

Parts List

No.	Qty.	Part #	Description	Torque
1	2	372040AA	Front & Rear Bracket (passenger side)	
2	2	372040BA	Center Bracket (passenger side)	
3	2	372040AA	Front & Rear Bracket (driver side)	
4	2	372040BA	Center Bracket (driver side)	
5	1		Passenger Side Step	
6	1		Driver Side Step	
7	12		3/8" -16 x 1-1/4" Hex Bolt	30 Ft. Lbs
8	12		3/8" Flat Washer	
9	12		3/8" Lock Washer	
10	16		M8-1.25 x 25mm Hex Bolt	20 Ft. Lbs
11	16		M8-1.25 Clip-Nut	
12	16		5/16" Flat Washer	
13	16		5/16" Lock Washer	

Front & Rear Bracket (passenger side)

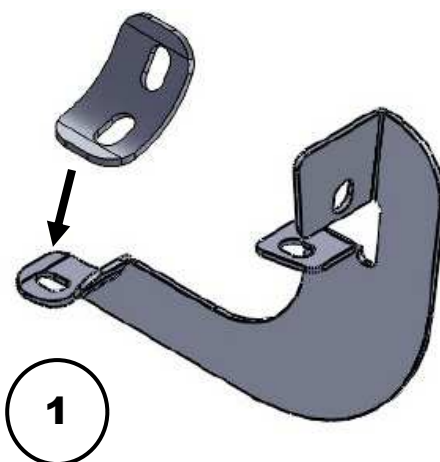

Center Bracket (passenger side)

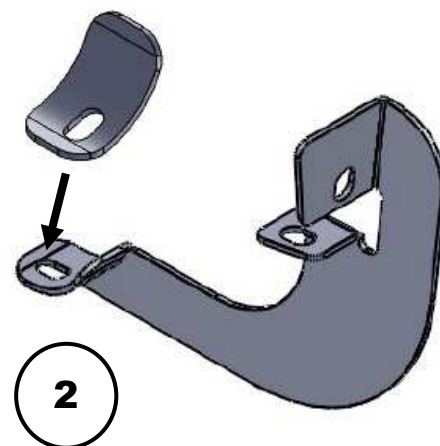

Tool Required:

13mm & 9/16" Socket

13mm & 9/16" Wrench

Ratchet & Ratchet Extension

Approximate installation time: 60 min

Read the installation instructions completely and verify that all of the parts listed are accounted for. If you have defective, missing or damaged parts or need assistance, please contact *Go Rhino Products* for fast, friendly customer service at: 1-888-427-4466 or email: warranty@gorhino.com

Installation

This installation uses 4 brackets per side, (Photo 1).

Photo 1

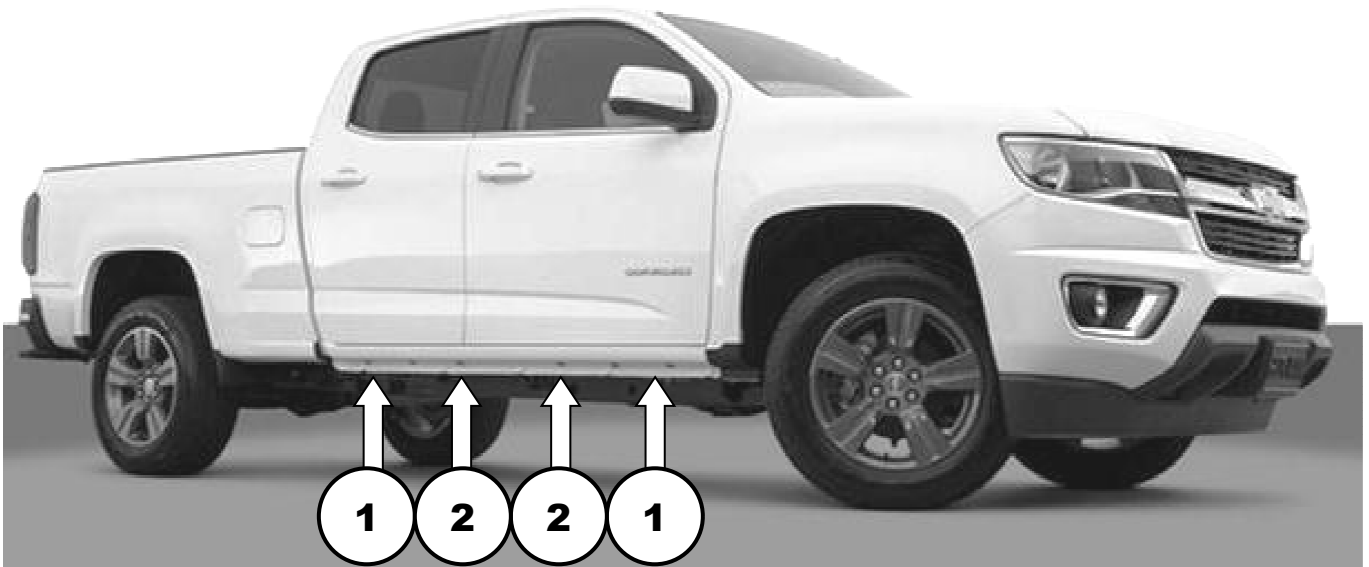

Step-1 Begin the installation on the passenger side. Starting at the front of the vehicle, locate and remove the plastic plugs in the back side and bottom of rocker panel to expose the holes used for placement of the M8 Clip- Nuts, (Photo 2).

Step-2 Install M8 Clip-Nuts in the rocker panel with the threaded end centered over the smaller hole, (Photo 3).

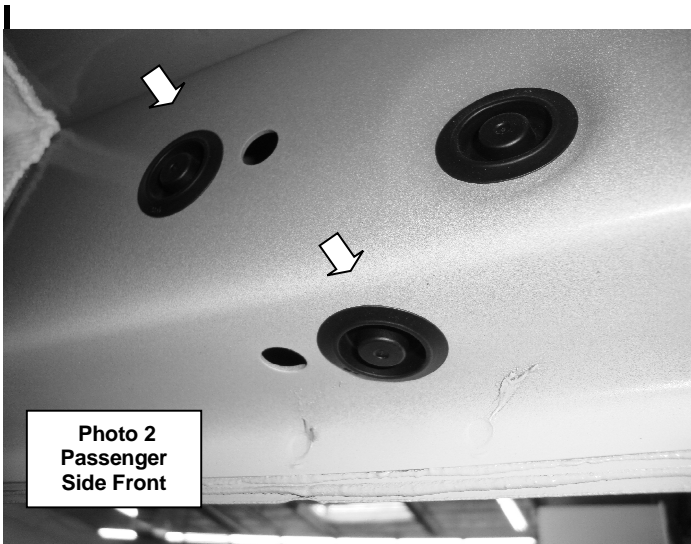

Photo 2
Passenger
Side Front

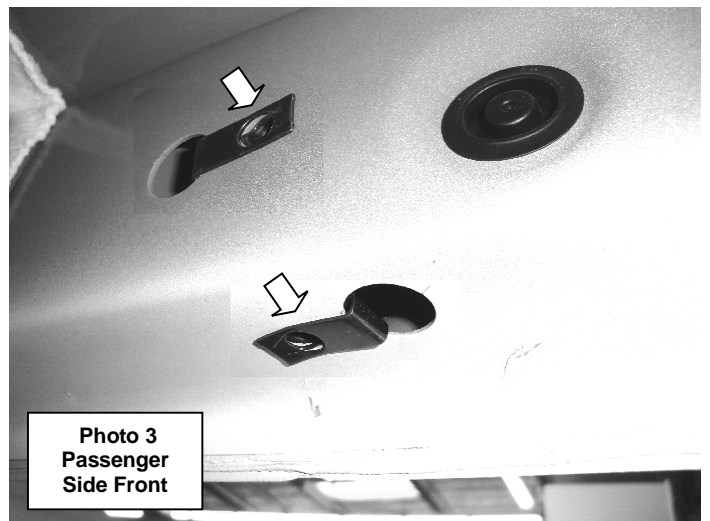
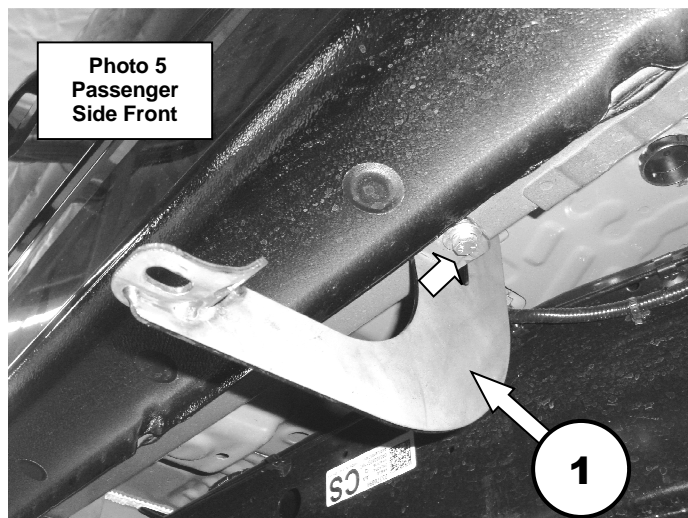
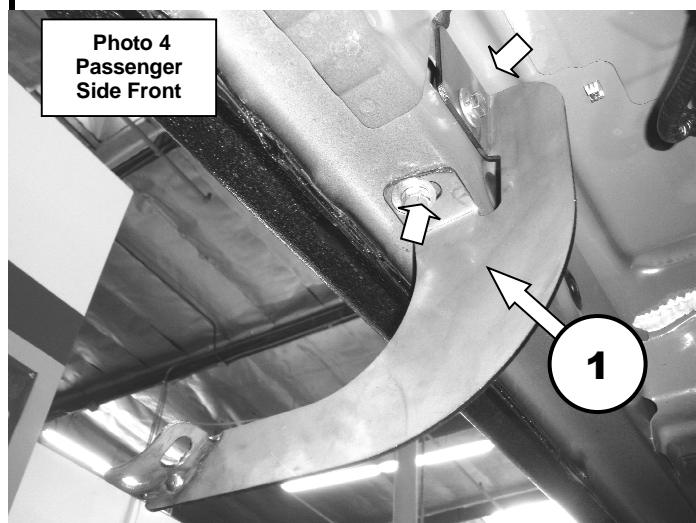
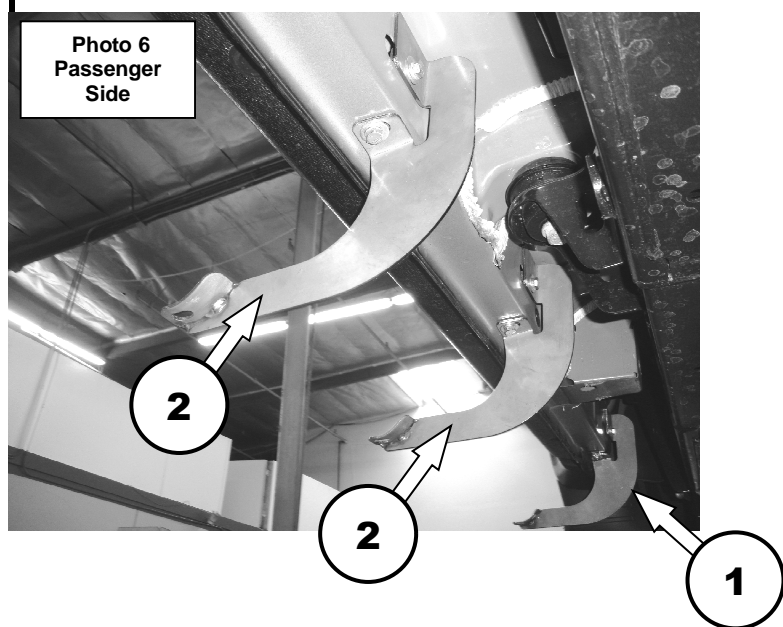

Photo 3
Passenger
Side Front

Step-3 Attach the passenger side front bracket to the rocker panel using (2) M8 hex bolts, (2) 5/16" flat washers and (2) 5/16" lock washers, (Photo 4 & 5). Leave the bolts loose for final adjustment.



Step-4 Locate the plastic plugs and holes in the rocker panel at the center and rear of the cab, and repeat steps 1-3 to install the two center and rear bracket, (Photo 6 & 7). Leave the bolts loose for final adjustment.



Step-5 Attach the passenger side step to the front and rear bracket using (2) 3/8" x 1 1/4" hex bolts, (2) 3/8" flat washers and (2) 3/8" lock washers, and to the center brackets using (1) 3/8" x 1 1/4" hex bolt, (1) 3/8" flat washer, and (1) 3/8" lock washer, (Photo 8 & 9).

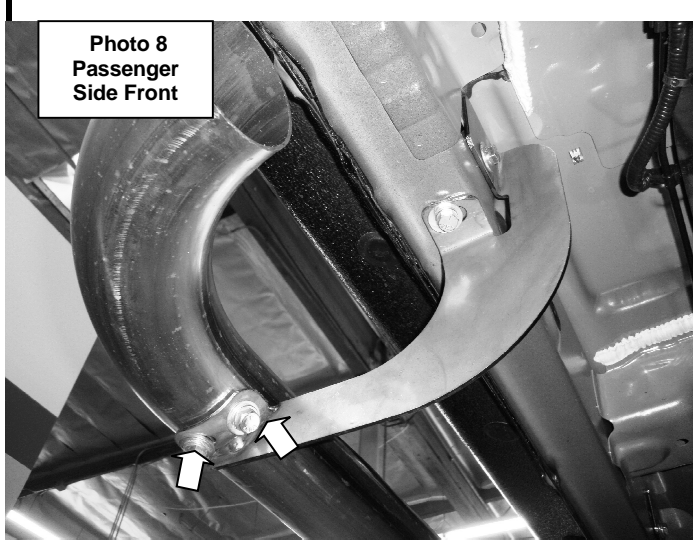

Step-6 Align the side step with the vehicle and tighten all bracket and side step bolts, (Photo 10). Repeat the above steps to install the driver side brackets and side step. Remember to check and retighten the bolts periodically.

