



GM 2019-2020 1500 and 2020 GM 2500/3500

Thank you for choosing Rough Country for all your vehicle needs.

If questions exist we will be happy to answer any questions concerning the design, function, and correct use of this product, please call us @1-800-222-7023.

READ BEFORE USING YOUR ROUGH COUNTRY IN-LINE SPEEDOMETER CALIBRATOR MODULE



Rough Country Inline Speedometer Calibrator Module Installation Instructions PN 90045 2019-2020 GM 1500 and 2020 GM 2500/3500

This installation manual shows an example installation on a 2019 Chevrolet 1500 New Style truck. The installation may vary for your vehicle, so it may be necessary to consult a GM service manual for specific instructions for your year model.

Be advised: These instructions may not include specifics for all vehicle configurations. Access our website to update your programmer.

1. This step makes sure that the programmer has the latest firmware installed. If Tuner Update Software is not already installed on your PC, go to our website and download the update software. Connect the Speedometer Calibrator to your PC with the supplied USB cable, run the update software and click the Update Tuner button.

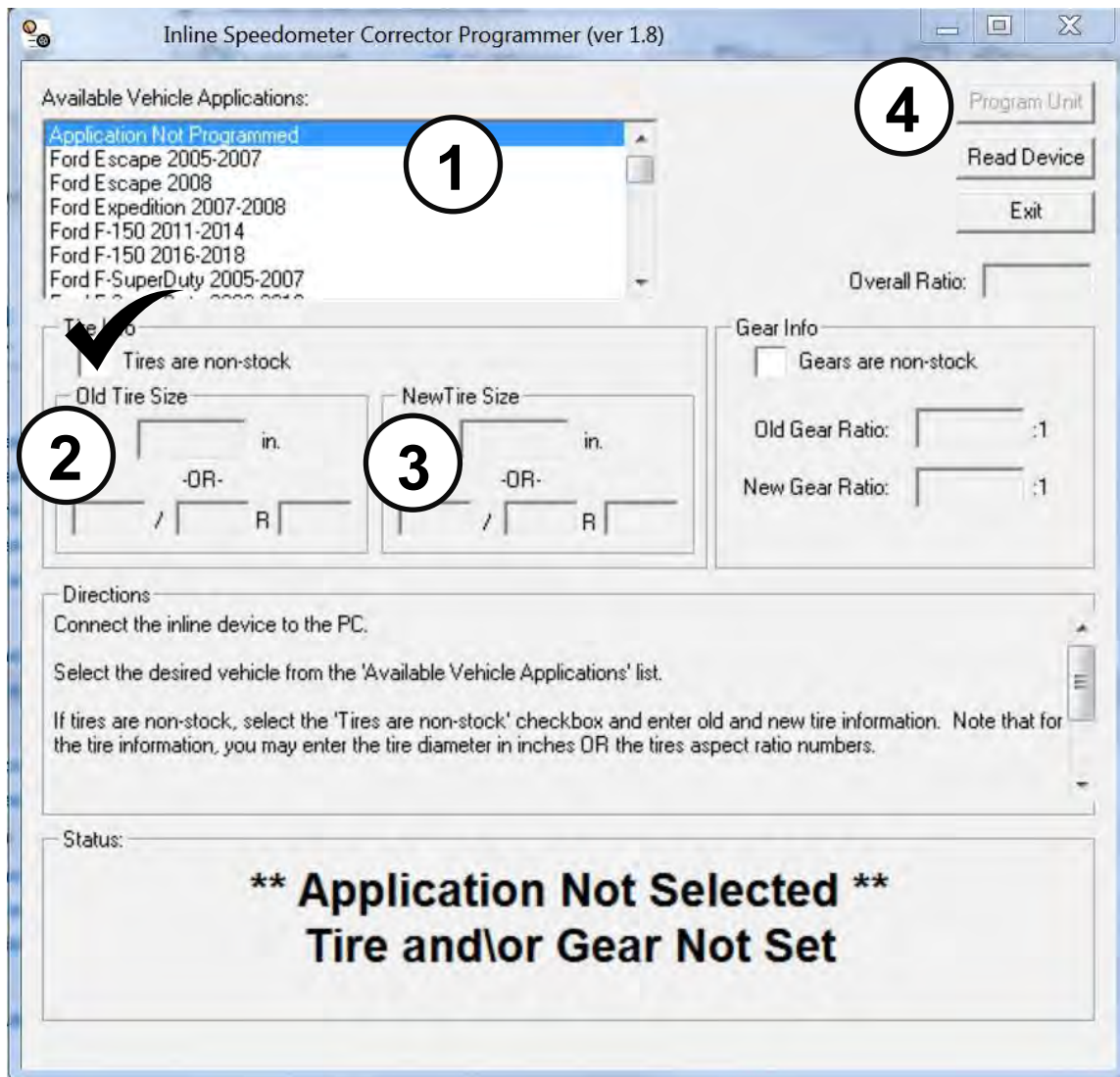

2. For accurate readings, measure the stock and new tire height from the ground to the top of the tire. Enter these measurements (in inches) into the configuration software, and click program to commit these settings. Once configuration is complete, take the Speedometer Calibrator module and harness to the vehicle.



- Looking up under the Driver's side dash, near the brake pedal, you will see a module with 7 color coded connectors. Remove the 1st White connector closest to you.



- Plug the male end of the Inline Speedometer Module Harness into the female end of the OE Harness.
- Plug the male end of the Speedometer Module Harness into the OE module and tuck the harness and Speedometer Module behind the kick panel.
- Start vehicle and check to ensure proper function.

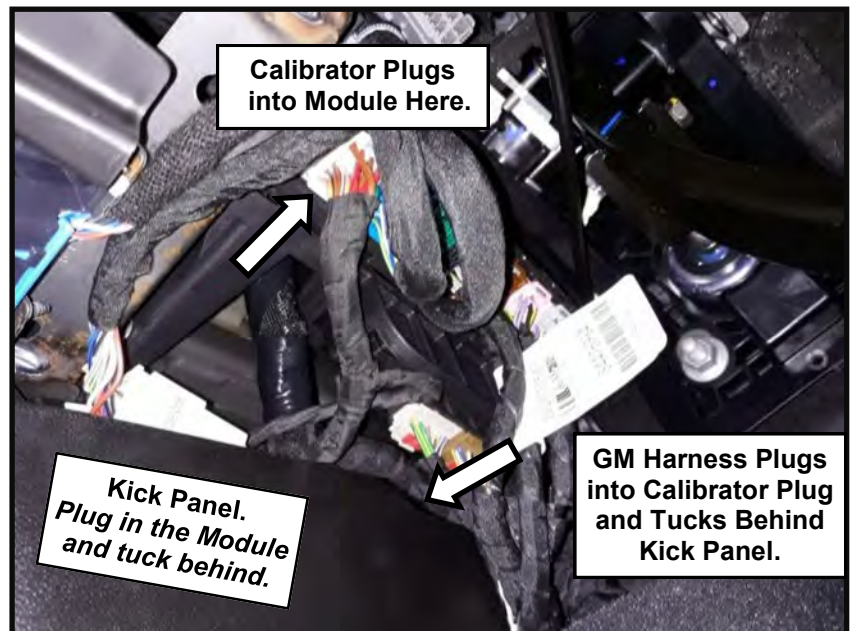

By purchasing any item sold by Rough Country, LLC, the buyer expressly warrants that he/she is in compliance with all applicable, State, and Local laws and regulations regarding the purchase, ownership, and use of the item. It shall be the buyers responsibility to comply with all Federal, State and Local laws governing the sales of any items listed, illustrated or sold. The buyer expressly agrees to indemnify and hold harmless Rough Country, LLC for all claims resulting directly or indirectly from the purchase, ownership, or use of the items.



