

INSTALLATION INSTRUCTIONS

HDX FRONT BUMPER LIGHT HOOP

APPLICATION:

Universal

PART NUMBER:

58-95-0035

WESTIN®

CONTENT

ITEM	QUANTITY	DESCRIPTION	TOOLS NEEDED
1	1	LIGHT HOOP ASSEMBLY	1/2" DRIVE RATCHET
2	2	SLIDING LIGHT BRACKET	3/4" SOCKET
3	2	1/2" HEX FLANGE NUT (YELLOW ZINC)	1/4" DRIVE RATCHET
4	2	1/2" HEX HEAD FLANGE BOLT (YELLOW ZINC)	7/16" SOCKET
5	4	1/4" HEX FLANGE NUT (YELLOW ZINC)	3/4" WRENCH
6	4	1/4" HEX HEAD FLANGE BOLT (YELOW)	7/16" SHORT WRENCH

ANTI-SEIZE LUBRICANT MUST BE USED ON ALL STAINLESS STEEL FASTENERS TO PREVENT THREAD DAMAGE AND GALLING



ITEM 1

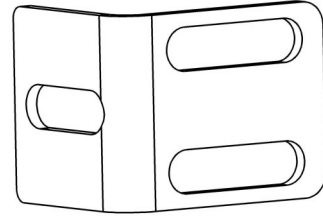

ITEM 2

PROCEDURE

1. Remove contents from box, verify if all parts listed are present and free from damage.
Carefully read and understand all instructions before attempting installation.
Failure to identify damage before installation could lead to a rejection of any claim.
2. Install Sliding Light Brackets (Item 2) to Light Hoop Assembly (Item 1) with supplied hardware; (4) 1/4" Hex Flange Nuts and (4) 1/4" Hex Flange Bolts. See **Figure 1**, (Note: **Install light with light manufacturer hardware.**)

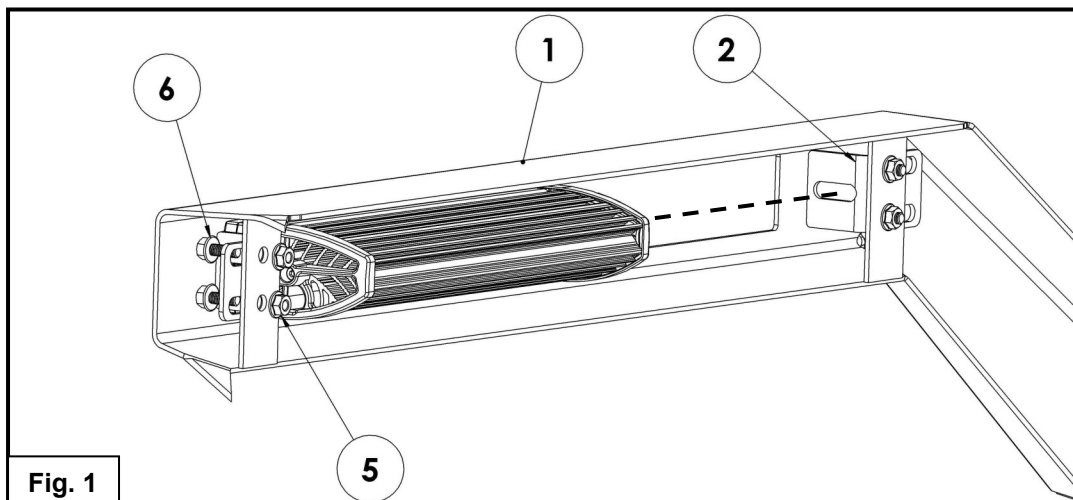

Fig. 1

WESTIN

Westin Automotive Products, Inc.
320 W. Covina Blvd
San Dimas, Ca. 91773

Thank you for choosing Westin products
for additional installation assistance please call
Customer Service (800) 793-7846

www.westinautomotive.com

DATE: 8/30/17

2. Install Light Hoop Assembly (Item 1) to Front Bumper with supplied hardware; (2) 1/2" Hex Flange Nuts and (2) 1/2" Hex Flange Bolts. See **Figure 2**
3. Torque hardware : 1/4" to 8 ft-lbs, 1/2" to 37 ft-lbs.

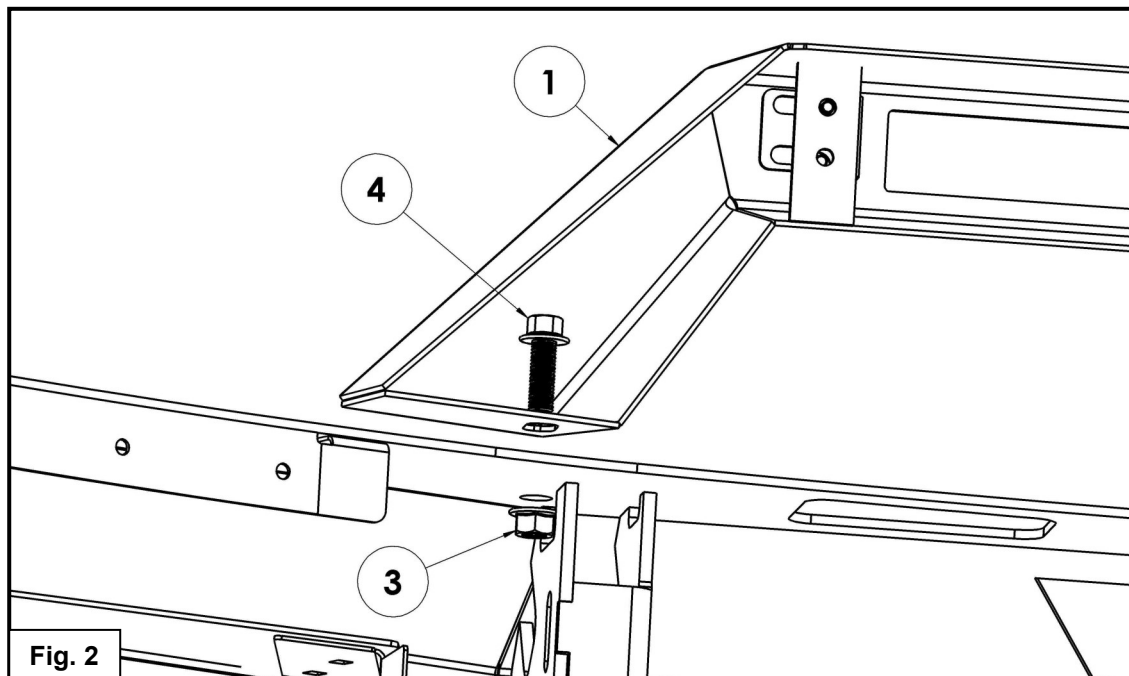

INSTALLATION COMPLETED



CARE INSTRUCTIONS

- REGULAR WAXING IS RECOMMENDED. DO NOT USE ANY TYPE OF POLISH OR WAX THAT MAY CONTAIN ABRASIVES
- STAINLESS STEEL PRODUCTS CAN BE CLEANED WITH MILD SOAP AND WATER. STAINLESS STEEL POLISH SHOULD BE USED TO POLISH SMALL SCRATCHES.
- GLOSS BLACK FINISHES SHOULD BE CLEANED WITH MILD SOAP AND WATER

WESTIN

Westin Automotive Products, Inc.
320 W. Covina Blvd
San Dimas, Ca. 91773

Thank you for choosing Westin products
for additional installation assistance please call
Customer Service (800) 793-7846
www.westinautomotive.com



AUTOMOTIVE PRODUCTS, INC.

WARNINGS & NOTICES

NOTICE

Westin Receiver Hitches are designed to accommodate a 2"- square receiver draw bar rated for class III/IV towing. Closely follow all Westin Installation Instructions for the proper installation of product. Improper installation can result in death, serious injury, and/or product and vehicle damage. In the operation of these products, it is imperative to observe precautions for your personal safety and the safety of others.



WARNING



Failure to follow these instructions could lead to death, personal injury, and / or property damage.

FASTENERS:

All Westin supplied fasteners must be utilized and installed in accordance with the installation instructions and apply torque to the specifications as defined. **DOUBLE CHECK ALL FASTENERS BEFORE INITIAL USE, AND PERIODICALLY IN THE FUTURE TO ENSURE PROPER FUNCTION AND SAFETY.**

DRILLING:

Most Westin products do not require drilling for installation. If drilling is defined as required, use caution when drilling a vehicle. **FAILURE TO REVIEW AN AREA TO BE DRILLED MAY RESULT IN PERSONAL INJURY AND/OR INJURY TO OTHERS AS WELL AS VEHICLE DAMAGE.**

EYE PROTECTION:

ALWAYS WEAR SAFETY GLASSES OR GOGGLES DURING THE INSTALLATION PROCESS TO AVOID PERSONAL INJURY.

MAXIMUM TOWING/CARRYING CAPACITY:

The Westin Receiver Hitches will have a visible tow rating label affixed directly on the product. User should never exceed the vehicle manufacturers maximum tow and weight rating regardless of the capacity of the hitch. **FAILURE TO FOLLOW THESE GUIDELINES WILL VOID THE WESTIN WARRANTY AND MAY RESULT IN PERSONAL INJURY AND/OR INJURY TO OTHERS AS WELL AS VEHICLE DAMAGE.**



Westin Automotive Products, Inc.
320 W. Covina Blvd
San Dimas, Ca. 91773

Thank you for choosing Westin products
for additional installation assistance please call
Customer Service (800) 793-7846
www.westinautomotive.com